

DRAWERED PIZZA PREP. TABLES

Side Mounted Condensing Unit

EPP – Series • EPPR1-D2 • EPPR2-D2 • EPPR2-D4 • EPPR3-D2 • EPPR3-D4



▲ EPPR1-D2



▲ EPPR2-D2



▲ EPPR2-D4



▲ EPPR3-D2



▲ EPPR3-D4

Cabinet Construction

Heavy duty stainless steel interior and exterior, with galvanized steel finished bottom and back wall of exterior. High quality 16 gauge stainless steel worktop, top lid and hood. 2.5" thick high density foamed-in-place polyurethane insulation. Four or six 4" diameter casters (front casters with brakes) with additional front weight support legs. Door and drawer heater installed around inside cabinet frame to prevent moisture build-up.

Refrigeration System

- Side mounted condensing unit for extra interior space compared to back mounted units
- Oversized condenser and evaporator coils quickly achieve and maintain desired temperature
- Forced-air cooling with multiple evaporator fan motors provide balanced airflow throughout cabinet to ensure faster temperature drop
- Removable side panel and slide-out condensing unit for convenient repair and maintenance
- Removable condenser coil air filter for easy cleaning
- Environmentally friendly CFC free R-134A refrigerant
- Air defrost, temperature initiated and terminated
- Copper tube and aluminum fin evaporator with anti-corrosive coating
- Energy efficient condensate drain pan assembly heated by high side copper tube
- Pressure relief ports for rapid re-entry
- Pre-wired and ready to plug, 115V/60Hz/1Ph, NEMA 5-15P

Shelving

- Epoxy coated wire shelves (*see next page for shelf quantity*)
- Stainless steel pilasters and shelf clips

Doors & Drawers

- High quality stainless steel interior and exterior
- 2.5" thick high density foamed-in-place polyurethane insulation
- Rounded corners for a comfortable and hazard-free work space
- Heavy duty adjustable torsion spring self-closing door system
- One piece snap-in magnetic door and drawer gaskets for easy replacement
- Heavy duty recessed door and drawer handles for a flat surface
- Heavy duty 304 stainless steel drawer frames with low-friction ball bearing slides (*note: refer to the website for pan configurations*)

Preparation Area

- 1/2" thick foam insulated detachable lids to prevent moisture build-up and heat exchange
- Removable and adjustable sanitary 19 1/4" deep cutting board
- Sanitary polycarbonate pans (*note: refer to the website for pan configurations*)

Temperature Control

- Factory preset temperature, 35°F
- Temperature setting range from 33°F to 54°F
- Easy to read digital temperature display
- Easy to program push-button temperature control
- Microchip digital control and monitoring system with a variety of functions to monitor and maintain optimum temperature



Dimensions

Air Flow

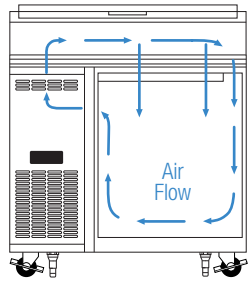

Front view of cabinet interior demonstrates air circulation from left to right.

Equipped with 9 ft long NEMA 5-15P plug.

Side View

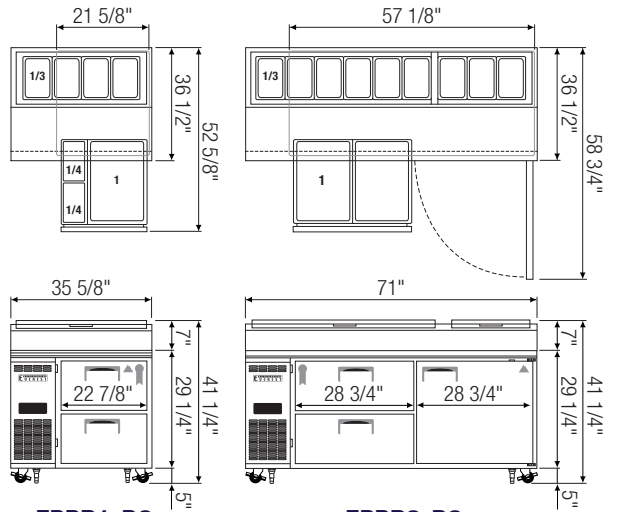
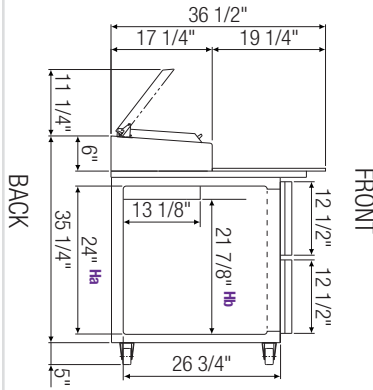

▲ EPPR1-D2

▲ EPPR2-D2

ABS Legs



Standard adjustable stainless steel clad ABS legs provide extra stability when opening and closing door.

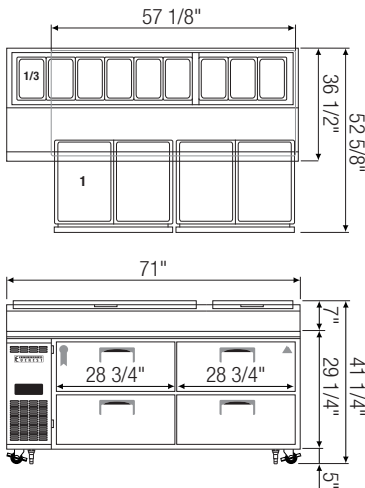

▲ EPPR2-D4

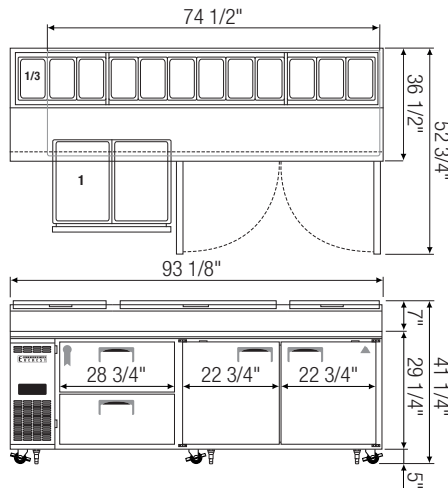

▲ EPPR3-D2

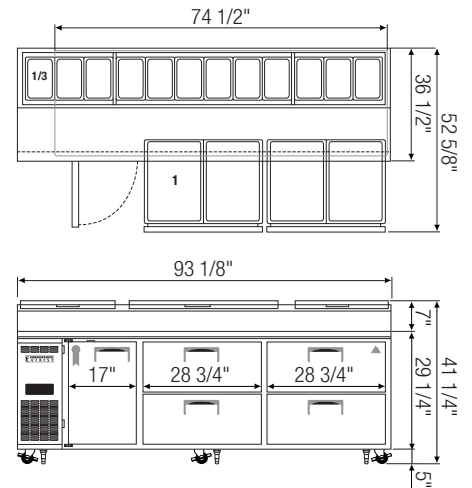

▲ EPPR3-D4

Model	Ref/ Frz/ Dual	# of Doors	Capacity (Cu.Ft.)	HP	Refrigerant	# of Shelves	# of Pans (Top)	# of Pans (Drawer)	Power (V-Hz-Ph)	Amps	Crated Weight (LBS)	Exterior Dimensions (Inches)			Interior Dimensions (Inches)		
												L	D ^a	H*	L	D	H
EPPR1-D2	Ref	2(DR)	9	1/4+	R-134A	N/A	1/3 x 4	1 x 2 1/4 x 4	115-60-1	3.97	309	35 5/8	36 1/2	36 1/4	21 5/8	26 3/4	24 Ha 21 7/8 Hb
EPPR2-D2	Ref	1(D) 2(DR)	23	1/3	R-134A	2	1/3 x 9	1 x 4	115-60-1	6.30	487	71	36 1/2	36 1/4	57 1/8	26 3/4	24 Ha 21 7/8 Hb
EPPR2-D4	Ref	4(DR)	23	1/3	R-134A	N/A	1/3 x 9	1 x 8	115-60-1	6.30	488	71	36 1/2	36 1/4	57 1/8	26 3/4	24 Ha 21 7/8 Hb
EPPR3-D2	Ref	2(D) 2(DR)	30	1/3+	R-134A	4	1/3 x 12	1 x 4	115-60-1	6.33	610	93 1/8	36 1/2	36 1/4	74 1/2	26 3/4	24 Ha 21 7/8 Hb
EPPR3-D4	Ref	1(D) 4(DR)	30	1/3+	R-134A	2	1/3 x 12	1 x 8	115-60-1	6.33	649	93 1/8	36 1/2	36 1/4	74 1/2	26 3/4	24 Ha 21 7/8 Hb

*: Height does not include 5" for casters; height includes top lid and handle.

a : Depth includes 19 1/4" cutting board.

† : Drawer pans are not included.

Ha, Hb : Interior Height

Ref = Refrigerator | (DR) = Drawer | (D) = Door

Specifications subject to change without notice.

Product dimensions are for general purposes and not absolute value. Product capacity(▶) is calculated based on standard industry figures. Slight variations may exist. If dimensions and capacity are critical, please contact Everest Refrigeration.



Please visit our website for updated Energy Efficiency information.