

SIDE MOUNT UNDERCOUNTER FREEZERS

Side Mounted Condensing Unit

ET – Series • ETF1 • ETF2 • ETWF2 • ETF3



▲ ETF1



▲ ETF2



▲ ETWF2



▲ ETF3

Cabinet Construction

Heavy duty stainless steel interior and exterior, with galvanized steel finished bottom and back wall of exterior. High quality 16 gauge stainless steel worktop, ABS evaporator drain cover. 2.5" thick high density foamed-in-place polyurethane insulation. Four 4" diameter casters (front casters with brakes). Door heater installed around inside cabinet frame to prevent moisture build-up.

Refrigeration System

- Side mounted condensing unit for extra interior space compared to back mounted units
- Oversized condenser and evaporator coils quickly achieve and maintain desired temperature
- Forced-air cooling with multiple evaporator fan motors provide balanced airflow throughout cabinet to ensure faster temperature drop
- Removable side panel and slide-out condensing unit for convenient repair and maintenance
- Removable condenser coil air filter for easy cleaning
- Environmentally friendly CFC free R-134A and R-404A refrigerant
- Adjustable, time-initiated defrost cycle of 3 to 12 hours with 350 watt defrost heater, both time and temperature terminated for fail-safe operation
- Copper tube and aluminum fin evaporator with anti-corrosive coating
- Energy efficient condensate drain pan assembly heated by high side copper tube
- Pressure relief ports for rapid re-entry
- Pre-wired and ready to plug, 115V/60Hz/1Ph, NEMA 5-15P

Lighting

- Shielded incandescent interior lighting

Doors

- Heavy duty stainless steel interior and exterior
- 2.5" thick foamed-in-place polyurethane insulation
- Rounded corners for a comfortable and hazard-free work space
- Heavy duty adjustable torsion spring self-closing door system
- One piece snap-in magnetic door gaskets for easy replacement
- Heavy duty recessed door handles for a flat surface
- Door locks

Shelving

- Two epoxy coated wire shelves per section
- Stainless steel pilasters and shelf clips

Temperature Control

- Factory preset temperature, – 4°F
- Temperature setting range from –10°F to 54°F
- Easy to read digital temperature display
- Easy to program push-button temperature control
- Microchip digital control and monitoring system with a variety of functions to monitor and maintain optimum temperature

Options

- 4" high stainless steel backsplash for worktop use
- 2 1/2" diameter casters (3 1/2" overall height)



Dimensions

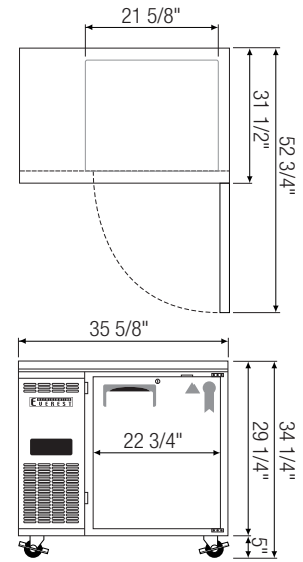
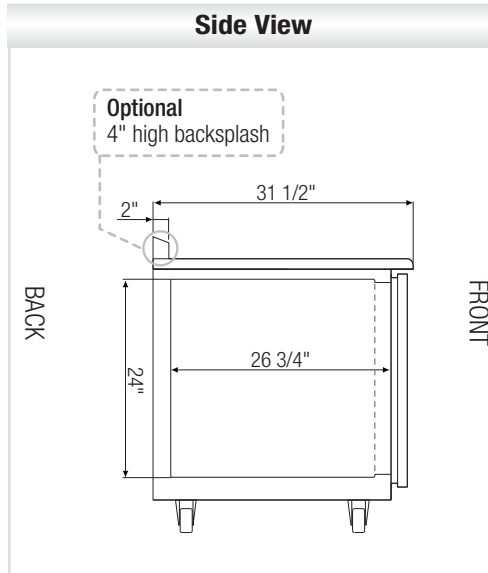
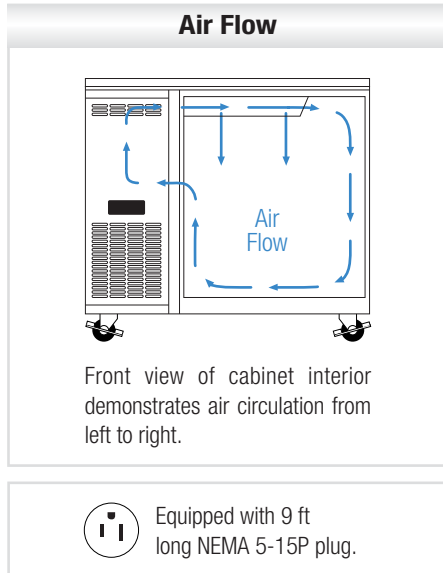

▲ ETF1

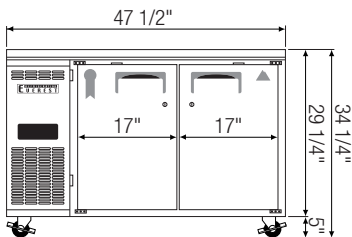
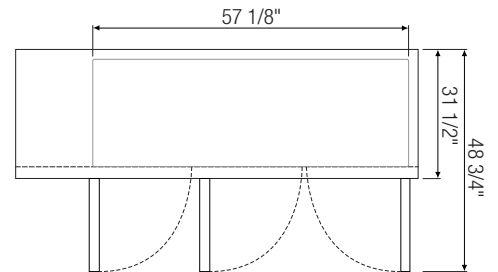
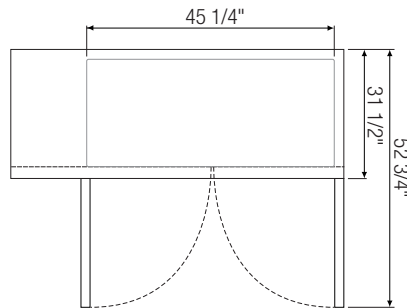
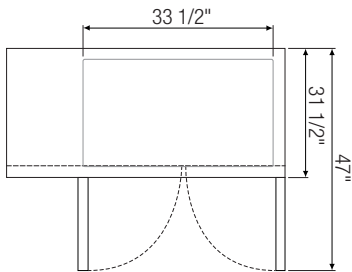

▲ ETF2

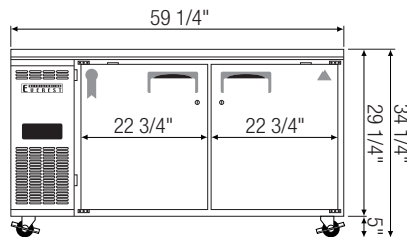

▲ ETWF2

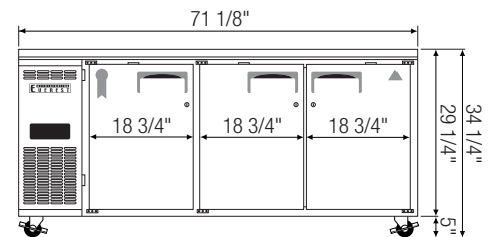

▲ ETF3

Model	Ref/ Frz/ Dual	# of Doors	Capacity (Cu.Ft.)	HP	Refrigerant	# of Shelves	BTU/HR †	Power (V-Hz-Ph)	Amps	Crated Weight (LBS)	Exterior Dimensions (Inches)			Interior Dimensions (Inches)		
											L	D	H *	L	D	H
ETF1	Frz	1	9	1/3	R-134A	2	2,041	115-60-1	4.24	193	35 5/8	31 1/2	29 1/4	21 5/8	26 3/4	24
ETF2	Frz	2	13	1/2	R-404A	4	3,435	115-60-1	7.50	264	47 1/2	31 1/2	29 1/4	33 1/2	26 3/4	24
ETWF2	Frz	2	18	1/2	R-404A	4	3,435	115-60-1	7.50	300	59 1/4	31 1/2	29 1/4	45 1/4	26 3/4	24
ETF3	Frz	3	22	1/2	R-404A	6	3,435	115-60-1	7.50	348	71 1/8	31 1/2	29 1/4	57 1/8	26 3/4	24

*: Height does not include 5" for casters.

† : Based on evaporating temperature of 14°F (-10°C) & condensing temperature of 131°F (55°C).

Frz = Freezer

Specifications subject to change without notice.

Product dimensions are for general purposes and not absolute value. Product capacity(▶) is calculated based on standard industry figures. Slight variations may exist. If dimensions and capacity are critical, please contact Everest Refrigeration.



Please visit our website for updated Energy Efficiency information.