

APPLICATION:

PRODUCT NAME:  
8" ADJUSTABLE WALL MOUNT FAUCET

JOB NAME:

- \_\_\_\_\_ SPECIAL CONFIGURATION  
(CHECK BASE MODEL AND OPTIONS)
- MODEL:
- 3250 W/ 6" SWING SPOUT
  - 3251 W/ 8" SWING SPOUT
  - 3252 W/ 10" SWING SPOUT
  - 3253 W/ 12" SWING SPOUT
  - 3254 W/ 14" SWING SPOUT
  - 9102 W/ 16" SWING SPOUT

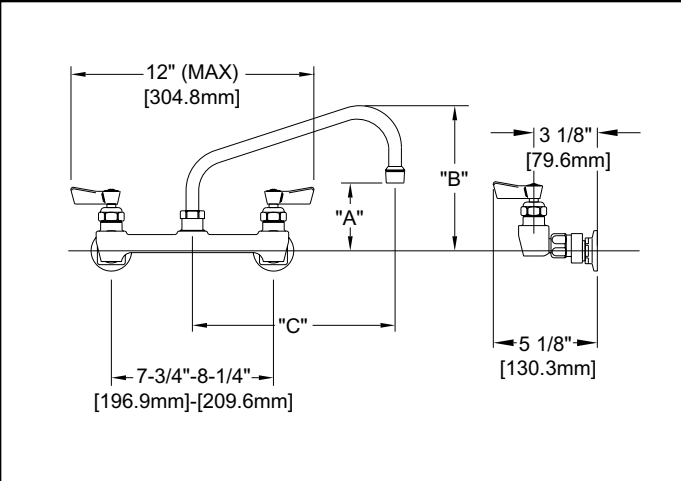

MODEL	DIM "A"	DIM "B"	DIM "C"
3250	2-1/4" [57.2mm]	5-7/8" [149.2mm]	6" [152.4mm]
3251	2-1/2" [63.5mm]	6-3/8" [161.9mm]	8" [203.2mm]
3252	3-1/8" [79.4mm]	6-7/8" [174.6mm]	10" [254.0mm]
3253	3-3/4" [95.3mm]	7-3/8" [187.3mm]	12" [304.8mm]
3254	4-3/8" [111.1mm]	8-1/4" [209.6mm]	14" [355.6mm]
9102	5" [127.0mm]	8-7/8" [225.4mm]	16" [406.4mm]

- OPTIONS OR MODIFICATIONS
- SUPPLY LINES (24" OR 36") CIRCLE LENGTH
  - DJ SUB-ASSY (7 1/4" OR 13") CIRCLE LENGTH
  - NIPPLES
  - ELBOWS
  - VANDAL RESISTANT KIT
  - HANDLES (CROSS OR WRIST) CIRCLE STYLE
  - OTHER \_\_\_\_\_

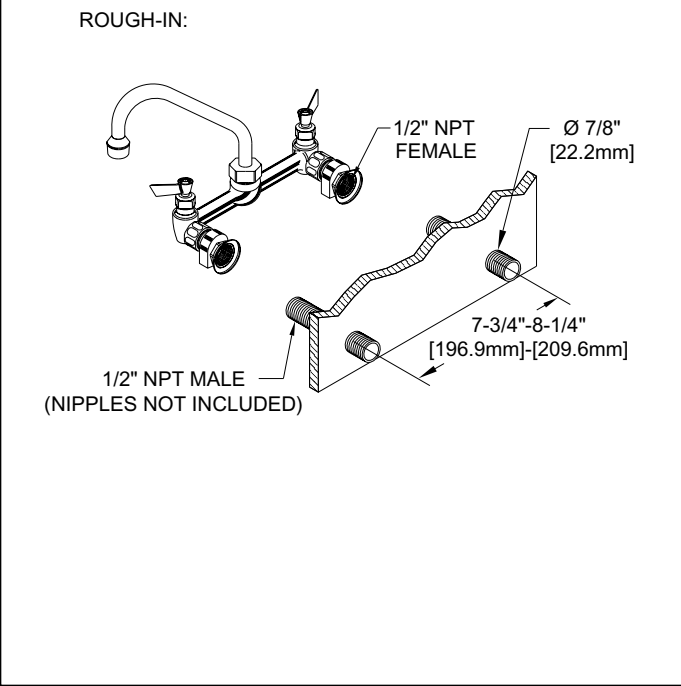

- FEATURES:
- \* 8" ADJUSTABLE WALL MOUNT
  - \* ECCENTRICS ADJUST FROM 7 3/4" TO 8 1/4"
  - \* SWIVELLING SEAT DISKS
  - \* HOT SIDE STEM - RIGHT HAND
  - \* COLD SIDE STEM - LEFT HAND
  - \* STAINLESS STEEL SEATS
  - \* STAINLESS STEEL SEAT SCREWS
  - \* STAINLESS STEEL HANDLE SCREWS
- SYSTEM LIMITS
- \* TEMP: 40°F MIN. TO 140°F MAX.
  - \* PRESSURE 200 PSI MAX. STATIC
  - \* 2.20 GPM AT 80 PSI

SHIPPING WEIGHT  
\* 5.0 LBS

Find this product at:  
**Central**  
RESTAURANT PRODUCTS

**1-866-285-1252**

**FISHER**

FISHER MANUFACTURING COMPANY  
TOLL FREE: 800-421-6162 - FAX: 800-832-8238  
information@fisher-mfg.com - www.fisher-mfg.com

ANSI/A112.18.1M