

APPLICATION:

PRODUCT NAME:
**POT FILLER HOSE STYLE
 SINGLE WALL MOUNT**

JOB NAME:

_____ SPECIAL CONFIGURATION
 (CHECK BASE MODEL AND OPTIONS)

QUANTITY:

ITEM NO.:

MODEL:
 2750

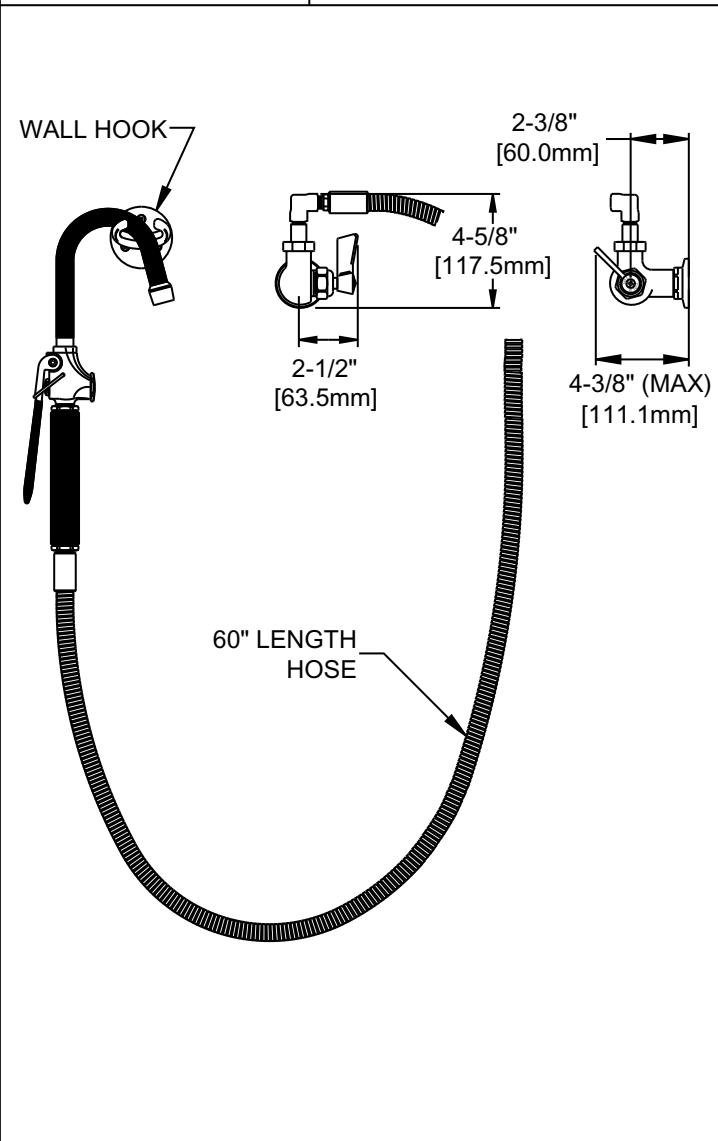

- OPTIONS OR MODIFICATIONS:
- SUPPLY LINES (24" OR 36") CIRCLE LENGTH
 - ADD-ON FAUCET (6",8",10",12",14",16") CIRCLE LGTH
 - BACKFLOW PREVENTER
 - PIPE HOOK
 - NIPPLES
 - ELBOWS
 - VANDAL RESISTANT KIT
 - HANDLES (CROSS OR WRIST) CIRCLE STYLE
 - OTHER _____

FEATURES:

- CONTROL VALVE
- * SINGLE WALL MOUNT
 - * STEM - RIGHT HAND
 - * SWIVELING SEAT DISKS
 - * HOT & COLD INDEX BUTTONS
 - * STAINLESS STEEL SEATS
 - * STAINLESS STEEL SEAT SCREWS
 - * STAINLESS STEEL HANDLE SCREWS

- HOSE
- * 60" LENGTH
 - * STAINLESS STEEL END FITTINGS
 - * STAINLESS STEEL EXTERNAL JACKET
 - * BRAIDED USDA APPROVED FOODGRADE INTERNAL HOSE
 - * REPAIRABLE IN FIELD WITH SIMPLE TOOLS

- POT FILLER VALVE
- * NON SCRATCHING/ MARRING TUBE
 - * 5.00 GPM AT 80 PSI
 - * AERATED STREAM

- SWIVEL ELBOW
- * 360° TURNING RADIUS

- SYSTEM LIMITS
- * TEMP: 40°F MIN. TO 140°F MAX.
 - * PRESSURE 200 PSI MAX. STATIC

- SHIPPING WEIGHT
- * 6.5 LBS

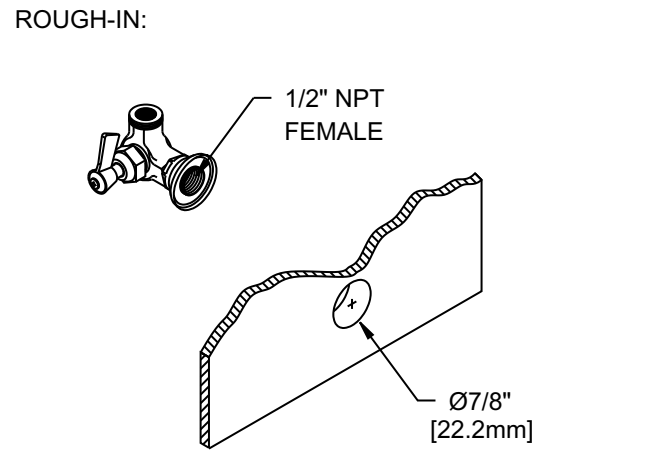

ANSI/A112.18.1M, ANSI/NSF 61.9

FISHER
 FISHER MANUFACTURING COMPANY
 TOLL FREE: 800-421-6162 - FAX: 800-832-8238
 information@fisher-mfg.com - www.fisher-mfg.com