



"MS4-SSK" Heavy Duty Machine Stands

w/ 14 Gauge Stainless Steel Work Top
w/ Stainless Steel Base



14 GAUGE TOP w/ STAINLESS
STEEL BASE

| 24"WIDE | Qty | 30"WIDE | Qty |
|-------------|-----|-------------|-----|
| MS4 2424SSK | | MS4-3030SSK | |
| MS4-2430SSK | | MS4-3036SSK | |

FEATURES:

- * 14 Gauge Stainless Steel Top
Type 300 stainless steel with # 4 polish, satin finish
- * Reinforced with 1"x 2" channel running entire length of table
- * Stainless Steel Legs and Shelve
- * Shelve adjustable to desired height
- * Adjustable bullet feet
- * Shipped knocked-down, easy - to - assemble
- * All models are approved by the National Sanitation Foundation and

CONSTRUCTION:

Top: Stainless Steel Tops are TIG welded, Exposed welds are polished to match adjacent surface.

Base: Stainless Steel frame is MIG welded

MATERIAL:

Top: 14 gauge Stainless Steel
Type 300 stainless steel with # 4 polish, satin finish

Shelve: 18 gauge Stainless Steel

Gussets: Stainless Steel

Feet: 1" adjustable Stainless Steel bullet feet

John Boos & Co

315 South First Street - Effingham, IL 62401
Phone: 217-347-7701 - Fax: 217-347-7705
Email: sales@johnboos.com - Web-site: www. johnboos.com

DETAILED SPECIFICATIONS

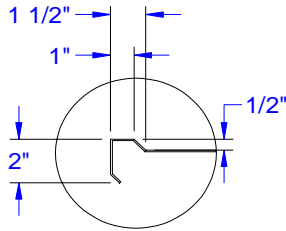
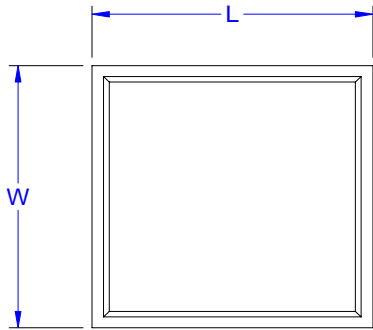

**MARINE EDGE
DETAIL**

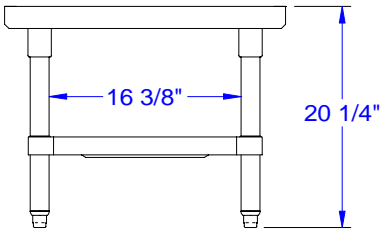
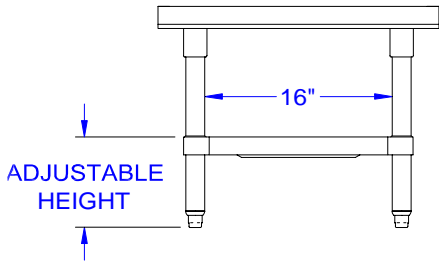

All units ship unassembled for reduced shipping cost.
 All dimensions are typical.
 Tolerance +/- .500".

14 GAUGE TOP & BRACING

| L | 24" WIDE | WT. | 30" WIDE | WT. |
|----|-------------|-----|-------------|-----|
| 24 | MS4-2424SSK | 34 | MS4-3030SSK | 43 |
| 30 | MS4-2430SSK | 38 | MS4-3036SSK | 52 |

John Boos & Co

315 South First - Effingham, IL 62401 Phone: 217-347-7701 - Fax: 217-347-7705
 Email: sales@johnboos.com - Web-site: www.johnboos.com



November 2010

John Boos is constantly engaged in a program of improving products and therefore reserves the right to change specification without prior notice