



# STAINLESS STEEL ECONOMY STAINLESS STEEL WORK TABLES



Item #: \_\_\_\_\_ Qty #: \_\_\_\_\_  
 Model #: \_\_\_\_\_  
 Project #: \_\_\_\_\_



SLAG-X Series  
Flat Top

### FEATURES:

**SLAG** Top is furnished with 1 5/8" sanitary rolled rim on front and rear & square ends.

**SFLAG** Top is furnished with 1 5/8" sanitary rolled rim on front and square ends, and 1 1/2" backsplash on rear.

**KSLAG** Top is furnished with 1 5/8" sanitary rolled rim on front and square ends, and 5" backsplash on rear.

Two hat-channels stud welded under tabletop to reinforce and maintain a level work surface.

Aluminum die cast "leg-to-shelf" clamp secures shelf to leg eliminating unsightly nuts and bolts. Underself is fully adjustable.

### CONSTRUCTION:

All TIG welded. Exposed weld areas polished to match adjacent surface.

Top is sound deadened.

Roll formed embossed galvanized hat channels are secured to top by means of structural adhesive and weld studs.

Gussets welded to support hat channels.

### MATERIAL:

**TOP:** 16 gauge stainless steel type "430" series.

**SHELF:** 18 gauge stainless steel.

**LEGS:** 1 5/8" diameter tubular stainless steel. Stainless steel gussets. 1" adjustable stainless steel bullet feet.



SFLAG-X Series  
1 1/2" Backsplash



KSLAG-X Series  
5" Backsplash

SLAG & SFLAG SERIES					
W	L	Flat Top w/ Underself	WT.	1-1/2" Splash w/ Underself	WT.
24"	24"	SLAG-242-X	31 lbs.	SFLAG-242-X	31 lbs.
	30"	SLAG-240-X	49 lbs.	SFLAG-240-X	49 lbs.
	36"	SLAG-243-X	64 lbs.	SFLAG-243-X	64 lbs.
	48"	SLAG-244-X	69 lbs.	SFLAG-244-X	69 lbs.
	60"	SLAG-245-X	92 lbs.	SFLAG-245-X	92 lbs.
	72"	SLAG-246-X	109 lbs.	SFLAG-246-X	109 lbs.
	84"	SLAG-247-X	126 lbs.	SFLAG-247-X	126 lbs.
	96"	SLAG-248-X	145 lbs.	SFLAG-248-X	145 lbs.
30"	24"	SLAG-302-X	42 lbs.	SFLAG-302-X	42 lbs.
	30"	SLAG-300-X	50 lbs.	SFLAG-300-X	50 lbs.
	36"	SLAG-303-X	71 lbs.	SFLAG-303-X	71 lbs.
	48"	SLAG-304-X	83 lbs.	SFLAG-304-X	83 lbs.
	60"	SLAG-305-X	94 lbs.	SFLAG-305-X	94 lbs.
	72"	SLAG-306-X	108 lbs.	SFLAG-306-X	108 lbs.
	84"	SLAG-307-X	129 lbs.	SFLAG-307-X	129 lbs.
	96"	SLAG-308-X	144 lbs.	SFLAG-308-X	144 lbs.

5" SPLASH KSLAG SERIES			
W	L	5" Splash w/ Underself	WT.
24"	24"	KSLAG-242-X	43 lbs.
	30"	KSLAG-240-X	49 lbs.
	36"	KSLAG-243-X	54 lbs.
	48"	KSLAG-244-X	65 lbs.
	60"	KSLAG-245-X	76 lbs.
	72"	KSLAG-246-X	89 lbs.
	84"	KSLAG-247-X	107 lbs.
	96"	KSLAG-248-X	123 lbs.
30"	24"	KSLAG-302-X	50 lbs.
	30"	KSLAG-300-X	55 lbs.
	36"	KSLAG-303-X	62 lbs.
	48"	KSLAG-304-X	73 lbs.
	60"	KSLAG-305-X	87 lbs.
	72"	KSLAG-306-X	102 lbs.
	84"	KSLAG-307-X	122 lbs.
	96"	KSLAG-308-X	142 lbs.



Stainless Steel Bullet Feet standard on SLAG, MSLAG, SFLAG & KSLAG Series

All 8 ft. Tables Provided With 6 Legs



Customer Service Available To Assist You **1-800-645-3166** 8:30 am - 8:00 pm E.S.T.

Email Orders To: [customer@advancetabco.com](mailto:customer@advancetabco.com). For Smart Fabrication™ Quotes, Email To: [smartfab@advancetabco.com](mailto:smartfab@advancetabco.com) or Fax To: 631-586-2933

**NEW YORK**  
Fax: (631) 242-6900

**GEORGIA**  
Fax: (770) 775-5625

**TEXAS**  
Fax: (972) 932-4795

**NEVADA**  
Fax: (775) 972-1578

# DETAILS and SPECIFICATIONS

TOL  $\pm$  .500"

ALL DIMENSIONS ARE TYPICAL

## SLAG SERIES - Flat Top

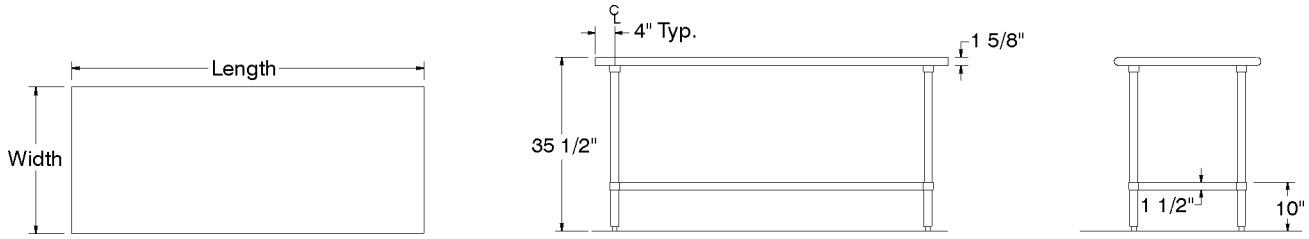

## SFLAG SERIES - 1 1/2" Backsplash

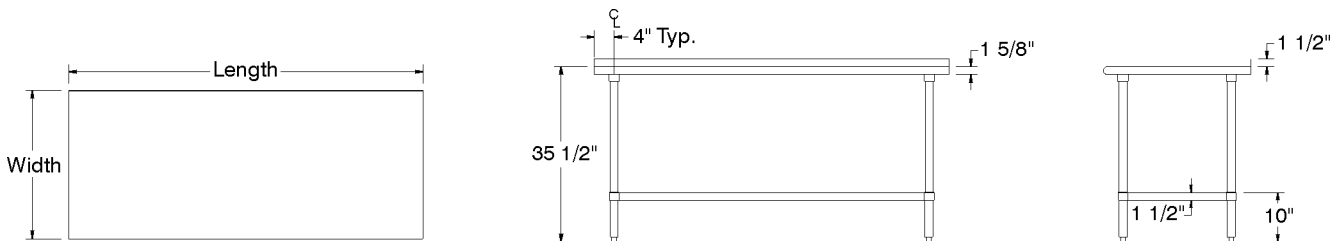

## KSLAG SERIES- 5" Backsplash

