



Project Name: _____

Location: _____

Item #: _____ Qty: _____

Model: _____

69K-901 UNDERCOUNTER ICE MACHINE - FULL DICE

MODEL: 69K-901



69K-901

The Kratos Ice 69K-901 indoor ice machine produces up to 60 pounds of ice per day (under ideal conditions). This stylish, durable and easy to install model is perfect for any freestanding or built-in application.

FEATURES AND CONSTRUCTION

- Stainless steel / black painted steel
- Air-cooled compressor
- Solid state controls
- Built-in self cleaning mode
- Automatic overflow prevention
- 25 lb storage bin
- Drain pump and internal blue LED light are included
- Field reversible door
- Adjustable durable feet
- Includes ice scoop & tubing for supply and drain lines

DAILY ICE PRODUCTION

Air Temp 70°F (21°C) / Water Temp 50°F (10°C)

69K-901 60 lbs (27.2 kg)

Air Temp 90°F (32°C) / Water Temp 70°F (21°C)

69K-901 51 lbs (23 kg)

ICE BIN STORAGE CAPACITY

69K-901 25 lbs (11 kg)

OPERATING REQUIREMENTS

Ambient Air Temperature Range..... 50° to 100°F (10° to 38°C)

Water Temperature Range 41° to 90°F (5° to 32°C)

Water Usage per 100 lbs of ice..... 13.8 Gallons (52.2L)

Water Supply Line Connection 1/4" O.D. Compression

Water Pressure Range:

Min PSI..... 15 Max PSI 75*

Min Bar 1.0 Max Bar 5.5

*Above 75 PSI requires a regulator

Energy Consumption per 100 lbs of ice:

69K-901 10.1 kWh/100 lbs

ELECTRIC

115V / 60Hz / 1Ph

5' (1.5m) NEMA 5-15P cord set included

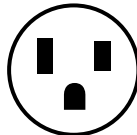

NEMA 5-15P

3RD PARTY APPROVALS



Certified to ANSI NSF 12



Certified to ANSI UL 563



DOE 2018 Compliant



Meets Energy Star Guidelines



Zero Ozone Depletion Potential

KRATOS ICE WARRANTY (USA)

One (1) year parts and on-site labor

Contact Central Restaurant Products for warranty statement at www.centralrestaurant.com or 888.908.8051

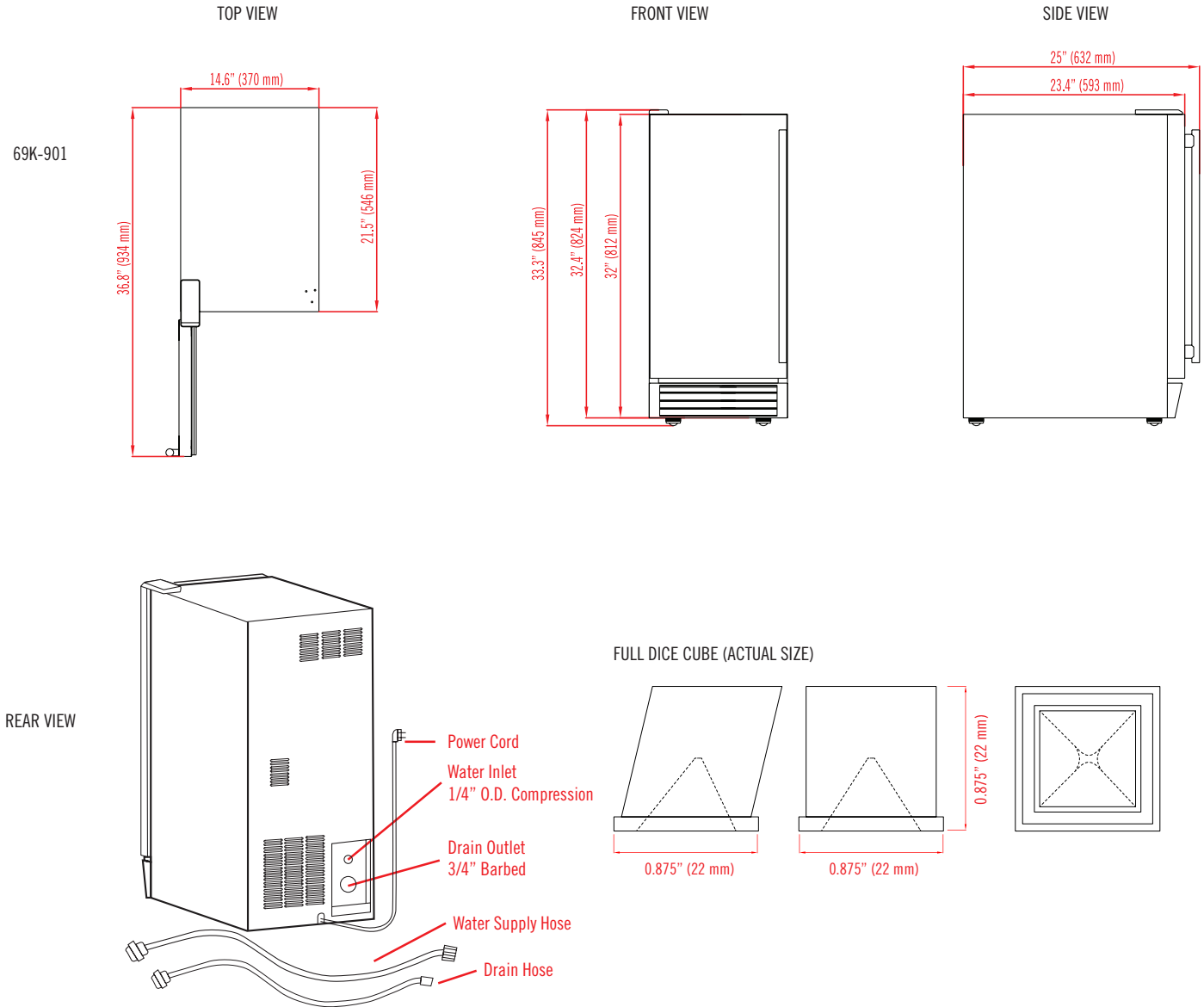

MODEL	EXTERNAL DIMENSIONS	DAILY ICE PRODUCTION (70°F Air / 50°F Water)	ICE BIN STORAGE CAPACITY	NET WEIGHT / SHIPPING WEIGHT	AMP DRAW (MAKING / HARVESTING)	REFRIGERANT AND CHARGE SIZE	ELECTRICAL
69K-901	14.6" x 25" x 33.3" (370 x 632 x 845 mm)	60 lbs (27.2 kg)	25 lbs (11 kg)	84 lbs (38 kg) 93 lbs (42 kg)	3A / 4A	R-134a 3.88oz (110g)	115V / 60Hz / 1Ph

INSTALLATION

- A clearance of 2" from the wall is recommended to promote adequate cooling air circulation
- A gravity drain line is required to install this ice machine
- For optimal performance, the use of a water filter is recommended