



Model: _____ Item #: _____ Date: _____

Project: _____ Qty: _____ Approved By: _____

24" Liquid CO₂ Glass Froster Cabinet

Royal Series Underbar



GC24S-L

Built-in Glass Froster unit
Stainless Steel Door, Left Hinge

CABINET BODY SPECIFICATIONS

Top	18 gauge galvanized sub top.
Sides	20 gauge stainless steel.
Doors	Black vinyl or 20 gauge stainless steel (foamed-in-place).
Back & Bottom	20 gauge galvanized back. 18 gauge galvanized bottom.
Interior	Reinforced steel
Exterior	Black Vinyl Clad Models: 20 gauge stainless steel Stainless Steel Models: 20 gauge stainless steel
Insulation	2" thick foamed-in-place polyurethane

FEATURES

- High performance glass froster unit built into top
- Built-in LED light that activates when froster is used
- 18"W flat top drainboard with removable perforated insert
- 24" Cabinet with locking door and reinforced floor for CO₂ tank storage
- Froster unit includes rechargeable 12V battery (optional 100/240 V AC plug)
- High quality, stainless steel construction
- CO₂ tank not included (20 lb recommended)
- Weight: 125 lbs.

CO₂ FROSTER SPECIFICATIONS

Opening Size	7-11/16" x 7-11/16"
Gas Refrigerant	CO ₂ (food grade) Carbon Dioxide
Cylinder Type	CO ₂ Cylinder with Siphon tube (not included)
CO₂ Line Standard Length	Approx 10 ft. (including connection valve)
Power Supply	Rechargeable 12V battery - 100/240 V AC Plug
Power Input	100 - 240 V AC
Frequency	50 - 60 Hz
Max Power Capacity	50W

Model	Description
GC24B-L	Black Vinyl Door, Left Hinge
GC24B-R	Black Vinyl Door, Right Hinge
GC24S-L	Stainless Steel Door, Left Hinge
GC24S-R	Stainless Steel Door, Right Hinge

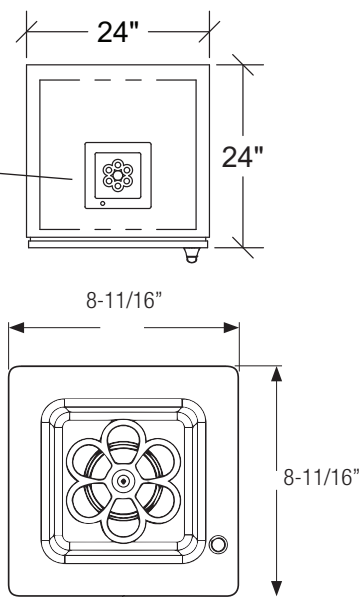
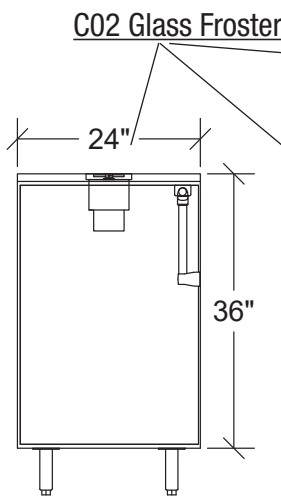
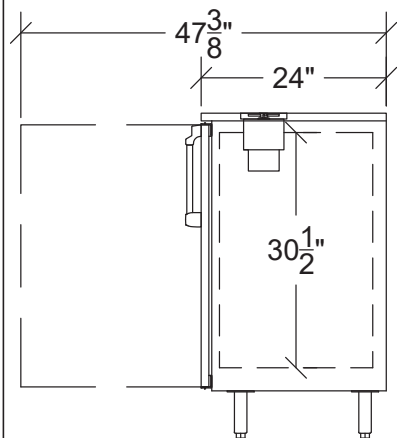

Warning: This product can expose you to chemicals including lead and lead compounds which are known to the State of California to cause cancer and birth defects or other reproductive harm. For more information go to www.P65Warnings.ca.gov.

Krowne Metal Corporation • 100 Haul Rd. Wayne, NJ 07470 • Toll Free: (800) 631-0442 • Fax: (973) 872-1129 • sales@krowne.com • krowne.com

Due to our commitment to continued product improvement, specifications are subject to change without notice.

Rev. 6/2020 • No. GC24 Cabinet