

SUPER DUTY NON-INSULATED TRANSPORT CABINET MODEL 100-1841-DSD

FEATURES AND BENEFITS:

- Non-insulated super-duty all purpose cabinet for rough handling during transport.
- Same size top and base extend past sidewalls to act as natural bumpers for protection. Extruded frame fully welded
- Body constructed of specially reinforced non-corrosive, Hi-Tensile aluminum for extra strength.
- Double reinforced, full length door swings 270° and can be latched to the cabinet side for convenience. Card clip included.
- Gravity type latch secures door during transport.
- Heavy duty hinges.
- Corrugated sidewalls securely hold 18" x 26" pans on 1-1/2" centers without tipping. Provides added strength.
- Heavy duty 5" swivel casters, two with brakes. Provides mobility when fully loaded.



100-1841-DSD
(Shown with optional corner bumpers)



ACCESSORIES and OPTIONS (Available at extra cost):

- Lock Hasp
- Various Caster Options
- Corner Bumpers
- Perimeter Bumper
- Floor Lock (for use with 5" casters)
- Push Handle
- Bail Handles
- Left-Hand Hinged Door
- Kold Keepers

See page A-20 for accessory details.

100-1841-DSD

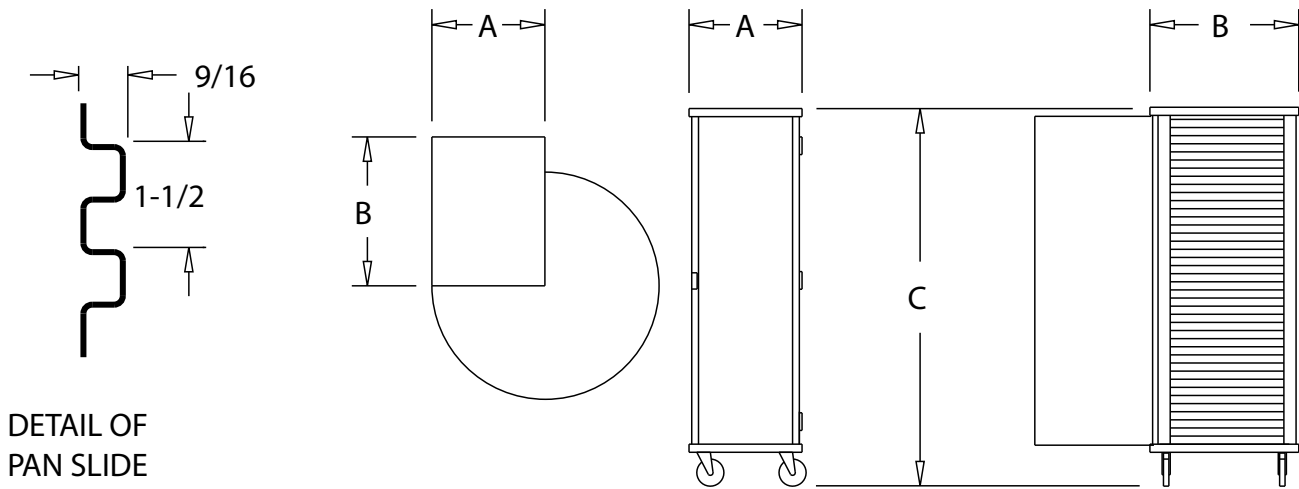

CRES COR MODEL NO.	PAN			DIM "A"	DIM "B"	DIM "C"	INSIDE DIMENSIONS			WEIGHT ACT.	
	CAP	SIZE		WIDTH	DEPTH	HEIGHT	WIDTH	DEPTH	HEIGHT		
100-1841-DSD	39	18 X 26	IN	20-7/8	27-1/2	69-3/4	18-1/16	26	61-1/2	LBS	108
		460 X 660	MM	530	700	1775	460	660	1565	KG	49

NOTE: Send sample pan or tray with order when using any that are not an 18" x 26" pan with heavy beaded edge. When ordering bumpers, add 2" to overall dimensions.

ALL ALUMINUM CONSTRUCTION IS RIVETED, WELDED AND FINISHED.

CABINET:

- Posts: Extruded channels, 7/8 x 2-1/4 x .102, welded to top and base, form a solid frame.
- Sides: .063 corrugations riveted to posts.
- SUPER DUTY back panel: Fitted into posts, riveted to top and reinforced with additional bracing.
- Tie rods: Two are applied at front
- Top: One piece .100 aluminum.

BASE:

- One piece construction, .190 aluminum.
- Casters: 5" dia., swivel, modulus tires, 1-1/4 wide, load cap. 250 lbs. each, temp. range -45°/+180°F. Delrin bearings. Front casters equipped with brakes.

DOOR:

- Panel: .063 aluminum, fitted into extruded frame, 3/4 x 1-7/16 x .187.
- SUPER DUTY reinforcement: Five 1/4 x 1-1/2 extruded bars riveted and welded horizontally.
- Latch: Gravity type, nickel plated steel.
- Swings 270° on 3 heavy duty butt hinges, riveted to posts and frame.

PAN SLIDES:

- Corrugations act as pan slides on 1-1/2" centers.

SHORT FORM SPECIFICATIONS

Cres Cor Super Duty Cabinet Model 100-1841-DSD. Formed and welded .100 aluminum top, .190 aluminum base. No-tip .063 corrugated aluminum sides for (39) 18" x 26" pans on 1-1/2" centers. .063 aluminum door; full frame welded construction. Two additional extruded bars riveted and welded to door and back. 5" swivel modulus casters, Delrin bearings. Load capacity 250 lbs. each. 2-Year Parts / 1-Year Labor warranty. Provide the following accessories: _____ NSF listed.



5925 Heisley Road • Mentor, OH 44060-1833
 Phone: 877/CRESCOR • Fax: 440/350-7267
 www.crescor.com

© Crescent Metal Products, Inc. 2011 All rights reserved.

In line with its policy to continually improve its products, CRES COR reserves the right to change materials and specifications without notice.

Litho in U.S.A.