



## Dish Storage Cabinets

Item #	_____	Qty	_____
Model #	_____		
Project	_____		



**AUTOQUOTES**



### 15" Deep Dish Cabinets

MODEL #	Length	Width	Height	Weight
4DCO4-1548	48"	15"	35"	155
4DCO4-1560	60"	15"	35"	195
4DCO4-1572	72"	15"	35"	225
4DCO4-1584	84"	15"	35"	265
4DCO4-1596	96"	15"	35"	295
4DCO4-15108	108"	15"	35"	332
4DCO4-15120	120"	15"	35"	360
4DCO4-15132	132"	15"	35"	380
4DCO4-15144	144"	15"	35"	400

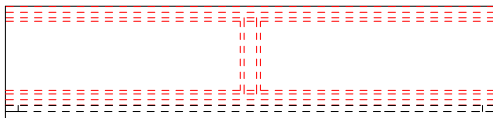

### 18" Deep Dish Cabinets

MODEL #	Length	Width	Height	Weight
4DCO4-1848	48"	15"	35"	170
4DCO4-1860	60"	15"	35"	205
4DCO4-1872	72"	15"	35"	245
4DCO4-1884	84"	15"	35"	275
4DCO4-1896	96"	15"	35"	315
4DCO4-18108	108"	15"	35"	354
4DCO4-18120	120"	15"	35"	385
4DCO4-18132	132"	15"	35"	432
4DCO4-18144	144"	15"	35"	452

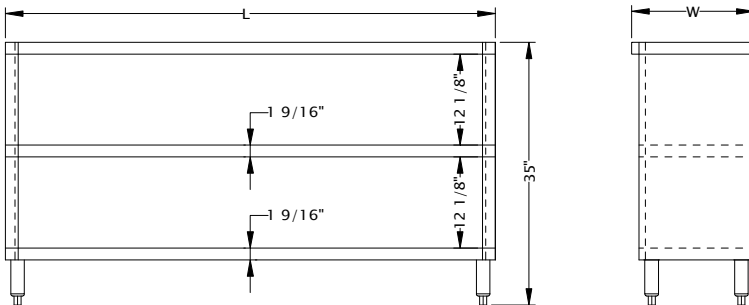

\*\* Weights are subject to additional packaging

### FEATURES:

- 14/300 stainless steel top
- 18/430 stainless Steel cabinet wrap with # 4 polish, satin finish

### CONSTRUCTION:

Top: Stainless Steel Tops are TIG welded, Exposed welds are polished to match adjacent surface.

### MATERIAL:

- Top: 14 Gauge type 300 stainless steel
- Shelf: 18 Gauge type 430 stainless steel
- Legs: Stainless Steel
- Gussets: Stainless Steel
- Feet: Stainless Steel

## John Boos & Co

3601 S. Banker Street - Effingham, IL 62401  
 Phone: 217-347-7701 - Fax: 217-347-7705  
 Email: sales@johnboos.com - Web-site: www.johnboos.com