

Project: _____	AIA# _____
Item #: _____ Qty: _____	SIS# _____
Model #: _____	

Lighted Liquor Displays



LLD2



LLD3



LLDG

Two Tier Models

LLD2-24, LLD2-30, LLD2-36, LLD2-42,
 LLD2-48, LLD2-54, LLD2-60

Three Tier Models

LLD3-24, LLD3-30, LLD3-36, LLD3-42,
 LLD3-48, LLD3-54, LLD3-60

Glass Ice Display Unit Models

LLDG-24, LLDG-30, LLDG-36, LLDG-42,
 LLDG-48, LLDG-54, LLDG-60

LLD Configurable Options

Power Cord Style:

- Type B - NEMA 5-15P (Default - North America)
- Type F (Europe)
- Type M (India)

Power Cord Location:

- Left or Right

Exterior Finish:

- Black vinyl-clad
- Stainless steel

LED Lighting:

- Bright white
- Warm white
- Adjustable multi-color

Standard Features

- Long lasting LED lighting
- On/off switch conveniently located on same side as power cord
- Available with two (LLD2 models) or three (LLD3 models) 4" high by 4" deep steps
- LLDG models have two steps and are designed for use in conjunction with Glastender Glass Ice Display Units. The first step is 9-1/4" high and a front light channel helps to illuminate the ice display.

Specifications

Electrical

- 100-240 VAC, 1 phase, 50/60Hz, less than 2 full load amps
- Includes on/off switch and 6-foot grounded cord and plug located on the left or right side as specified at time of order
- Adjustable multi-color option includes manual knob for color selection on same side as cord

Materials

- Black vinyl-clad steel parts include: standard front, back, and sides
- Stainless steel parts include: bottom, optional front, back, and sides
- Top consists of 1/8" thick opaque acrylic

Glastender, Inc. • 5400 N Michigan Rd • Saginaw, MI • 48604-9780 989.752.4275 • 800.748.0423 • Fax 989.752.4444 www.glastender.com	Approval/Notes:
Specifications subject to change without notice. For current specifications please visit our website.	

Lighted Liquor Displays

Dimensional Information

Dimensional Details for LLD2 Models

PLAN VIEW

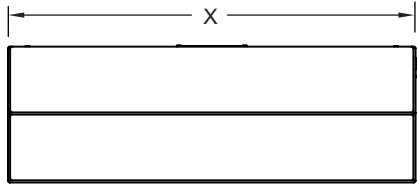

X = 24", 30", 36", 42", 48", 54", or 60"

FRONT VIEW

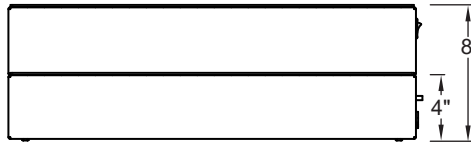

SIDE VIEW
(IF POWERCORD RIGHT)

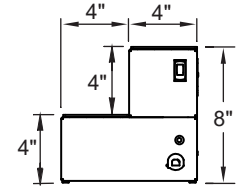

Dimensional Details for LLD3 Models

PLAN VIEW

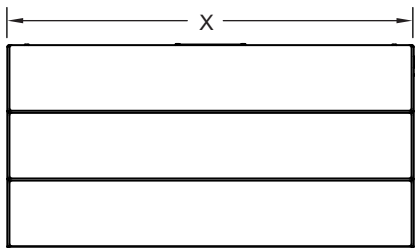

X = 24", 30", 36", 42", 48", 54", or 60"

FRONT VIEW

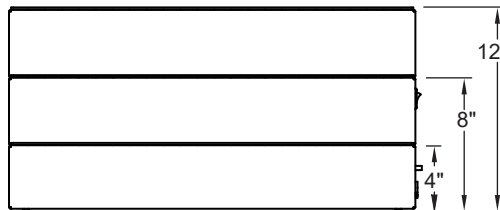

SIDE VIEW
(IF POWERCORD RIGHT)

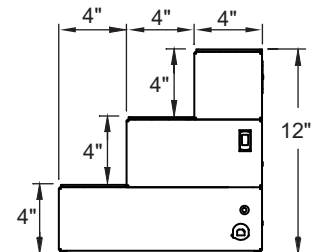

Dimensional Details for LLDG Models

PLAN VIEW

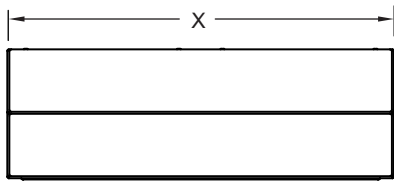

X = 24", 30", 36", 42", 48", 54", or 60"

FRONT VIEW

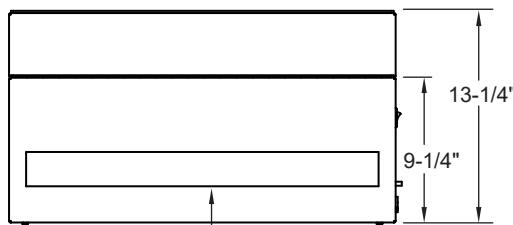

CLEAR ACRYLIC FRONT PANEL

SIDE VIEW
(IF POWERCORD RIGHT)

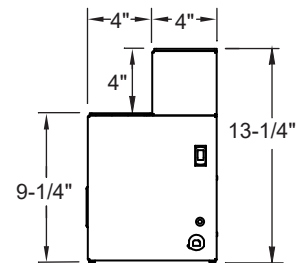

LLDG models are designed for use with Glastender Glass Ice Display Units. The 16" Deep GDU models mounted on a cooler at the factory have an 8-1/4" rear deck space specifically designed to fit the 8" deep LLDG. The 9-1/4" high first step of the LLDG raises the bottles above the back of the GDU and the front light channel helps to illuminate the GDU. (See the side view detail.)

SIDE VIEW OF LLDG
(WITH FACTORY INSTALLED 16" DEEP GLASS DISPLAY UNIT)

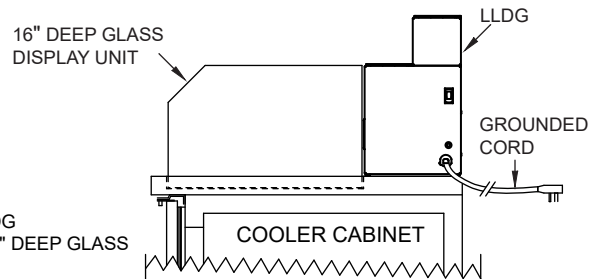

5400 N Michigan Rd • Saginaw, MI • 48604-9780
989.752.4275 • 800.748.0423 • Fax 989.752.4444
www.glastender.com

Printed in USA